

HOPE'n DOOR

1. Description

The HOPE'n Door device consists in a single piece that will be valid for both left and right oriented handles. It is also adaptable to any shape of door handle.

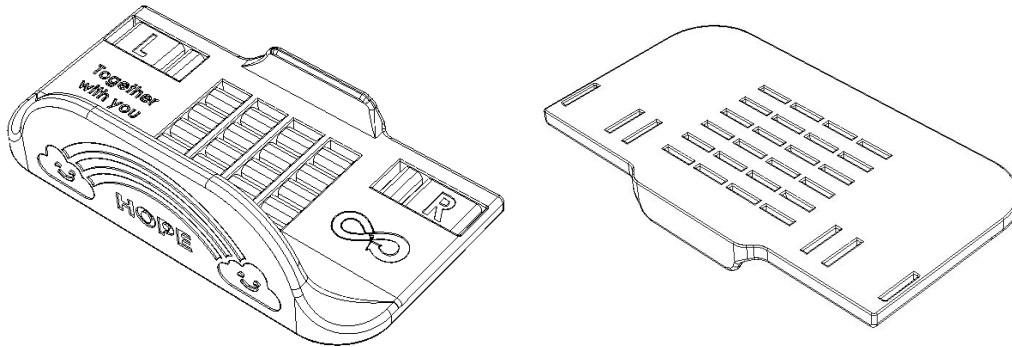

- Applicable for 3D printing:
 - **FDM** (Fused Deposition Modelling): Fill recommendation higher than 15%
 - **SLS** (Laser Sintering)
 - **MJF** (Multi Jet Fusion)
 - Also available for industrialization by plastic injection moulding process
 - More information: contact us hope@nortpalet.com

- Dimensions:

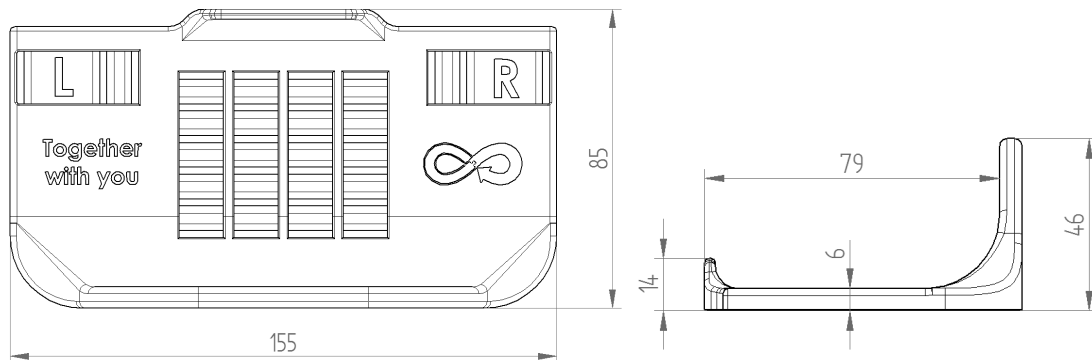

- Areas:

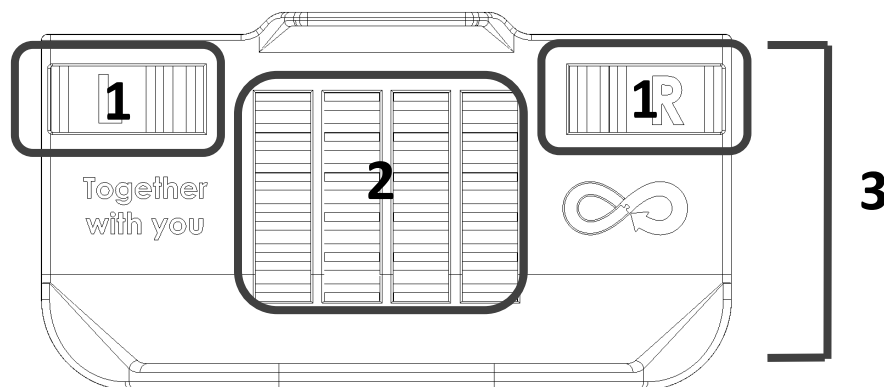

2. Compatibility

The device is compatible with almost all door handles available on the market. Below, the compatible range is represented:

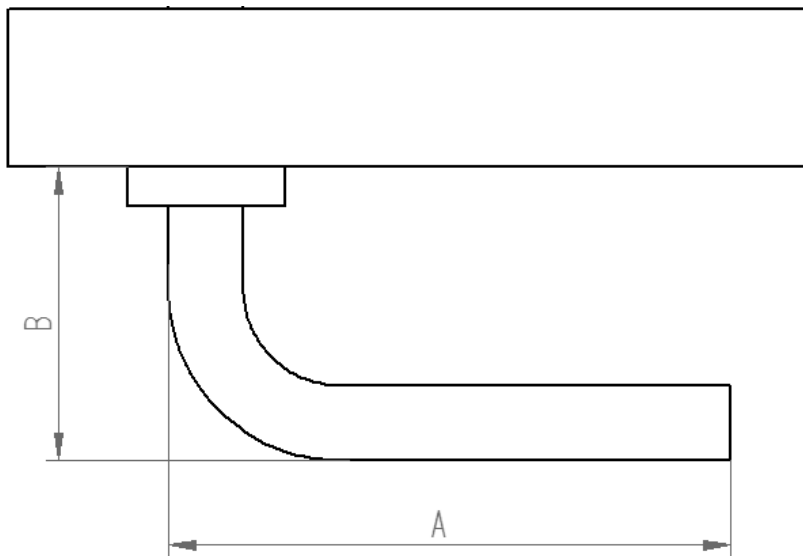



- [A] Handle length: ≤ 150 mm.
- [B] Handle depth: ≥ 40 mm y ≤ 80 mm.
- Handle section: any section and geometry are valid as long as the above restrictions are respected.

NOTE:

- If the previous dimensions are exceeded (only for the 3D printing version), there won't be any issue for set up the device, but the handle will be visible.
- It's designed to fit door handles with both right and left orientations.

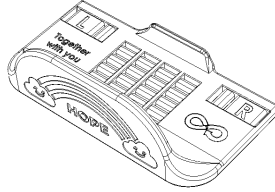
3. What you need for Set Up

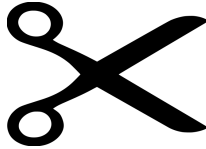
1	Device: 1 unit	
2	Cable ties: 2 units (recommended 3,6 x 140 mm)	
3	Scissors: 1 unit	

4. Set Up

- I. Place the device on top of the door handle

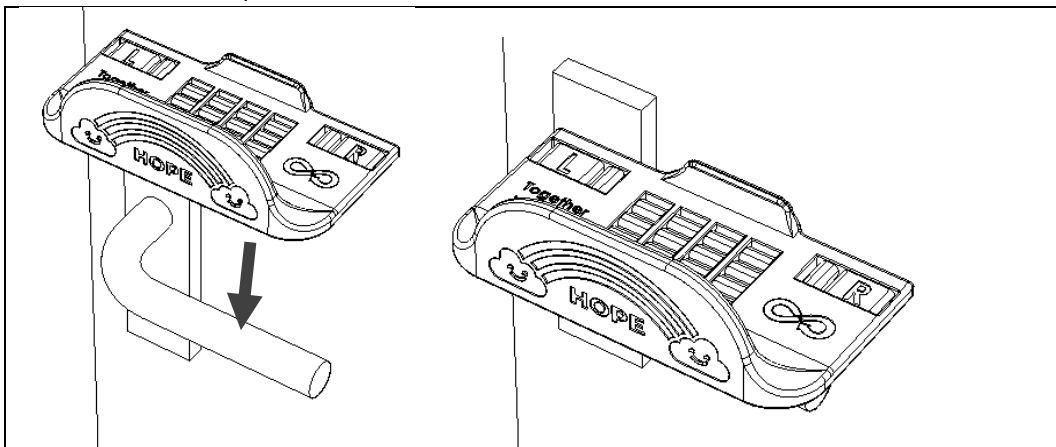

- II. Align area 1 of the device (left [L] or right [R]) with the middle line (axis) of the handle.

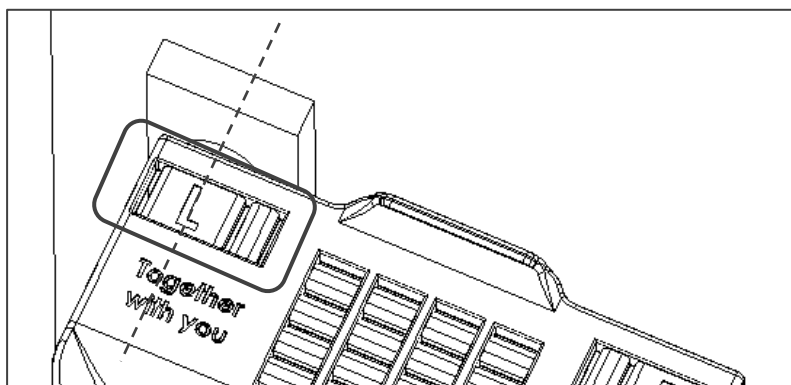

- III. Pass another tie cable to any groove area 2, so it can be fixed to the door handle.

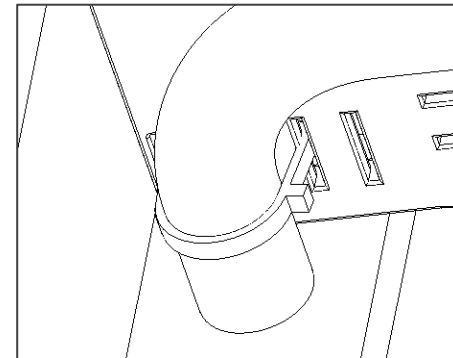
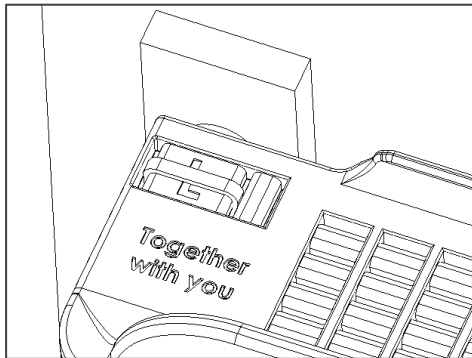
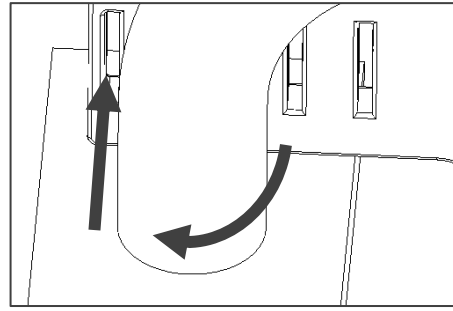
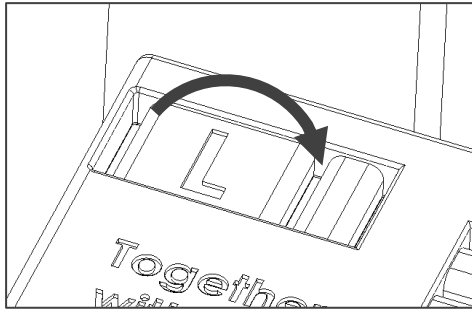

- IV. Pass another tie cable to any groove of the area 2, so it can be fixed to the door handle.

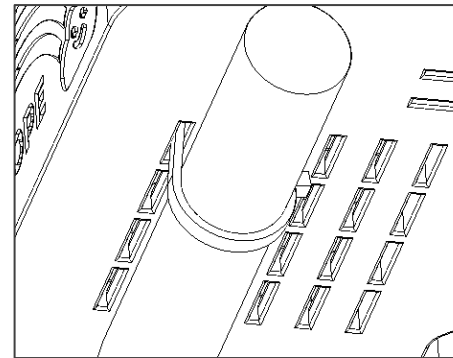
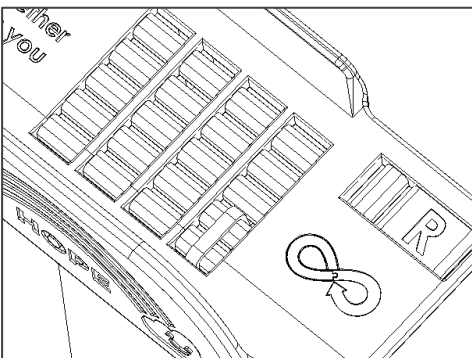
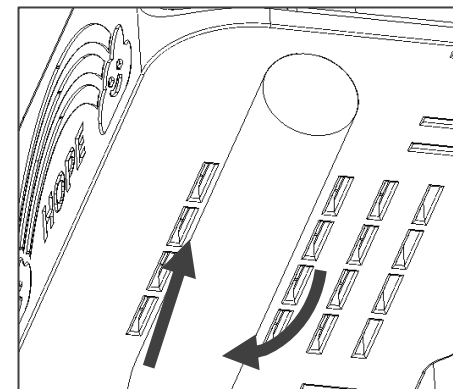
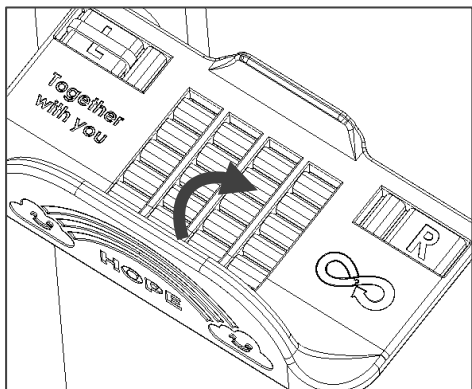

- V. Cut the excess of the cable ties with the scissors.

5. Operating mode

Place the forearm on the device (area 3), then lower the elbow to move down the handle.

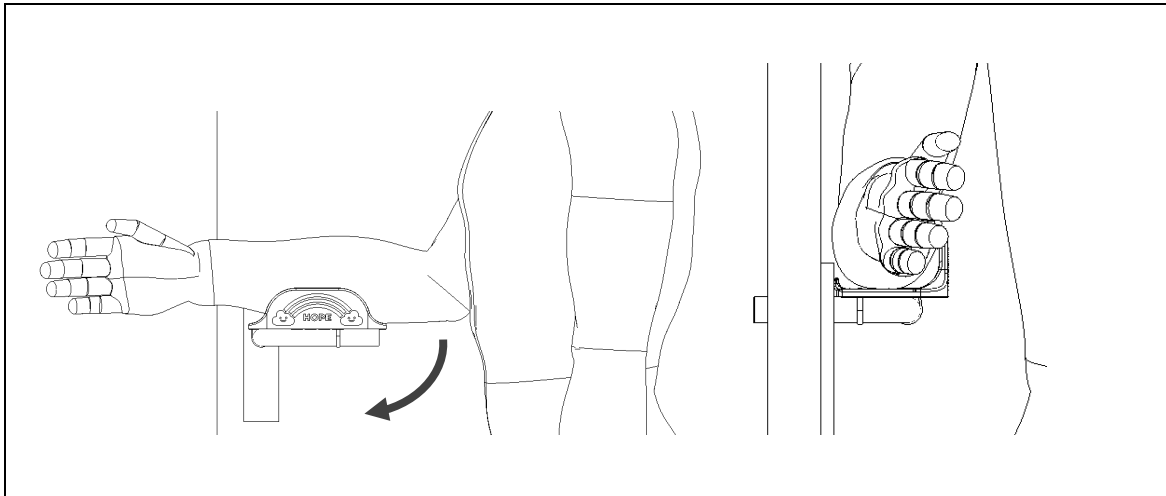

6. Recommendations

- I. For a better fixing, if it's necessary, you can use a second tie cable in area 2.
- II. Leave the head of the cable at the bottom, so it can be hidden and don't become an inconvenience.
- III. Tighten up the tie cables well for a better holding. Don't over tighten to avoid breaking the device.
- IV. Leave a small distance between the product and the door to avoid scratches when opening.